

2-flute flattened end mills with straight shank

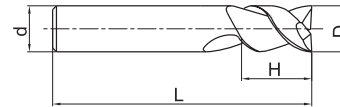

AL-2E

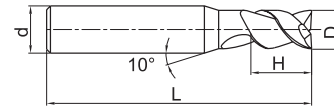

- Good chip removal performance, high machining efficiency.

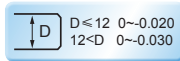
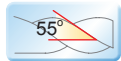

Type	Basic dimension(mm)				Number of teeth Z	Geometry	Stock
	D	d	H	L			
AL-2E-D1.0	1.0	4	3	50	2	Picture 1	●
AL-2E-D1.5	1.5	4	4	50	2	Picture 1	●
AL-2E-D2.0	2.0	4	6	50	2	Picture 1	●
AL-2E-D2.5	2.5	4	7	50	2	Picture 1	●
AL-2E-D3.0	3.0	6	9	50	2	Picture 1	●
AL-2E-D4.0	4.0	6	12	50	2	Picture 1	●
AL-2E-D5.0	5.0	6	15	50	2	Picture 1	●
AL-2E-D6.0	6.0	6	18	60	2	Picture 2	●
AL-2E-D8.0	8.0	8	20	60	2	Picture 2	●
AL-2E-D10.0	10.0	10	30	75	2	Picture 2	●
AL-2E-D12.0	12.0	12	32	75	2	Picture 2	●
AL-2E-D16.0	16.0	16	45	100	2	Picture 2	●
AL-2E-D20.0	20.0	20	45	100	2	Picture 2	●

● Stock available ○ Make-to-order

Indexable milling tools

Solid carbide end mills

AL series

➤ Applicable workpiece material table ○ Very suitable ○ Suitable

Workpiece material											
Carbon steel	Alloy steel	Pre-hardened steel, Hardened steel				Stainless steel	Cast iron, Nodular cast iron	Copper alloy	Aluminum alloy	Titanium alloy	Heat resistant alloy
		~40HRC	~50HRC	~55HRC	~68HRC						
								○			

Code key
B258

Graphics category and identification
B259

Cutting parameters
B549

Non-standard customization
B570-B571

AL/ALG series for machining aluminum

2-flute flattened end mills with straight shank and long cutting edge



AL-2EL

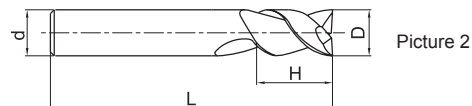
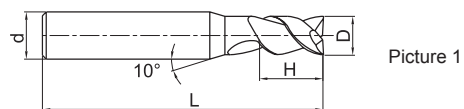

● AL-2E series with long cutting edge.

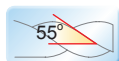

Type	Basic dimension(mm)				Number of teeth Z	Geometry	Stock
	D	d	H	L			
AL-2EL-D3.0	3.0	6	12	60	2	Picture 1	●
AL-2EL-D4.0	4.0	6	16	60	2	Picture 1	●
AL-2EL-D5.0	5.0	6	20	60	2	Picture 1	●
AL-2EL-D6.0	6.0	6	25	75	2	Picture 2	●
AL-2EL-D8.0	8.0	8	32	75	2	Picture 2	●
AL-2EL-D10.0	10.0	10	45	100	2	Picture 2	●
AL-2EL-D12.0	12.0	12	45	100	2	Picture 2	●
AL-2EL-D16.0	16.0	16	65	150	2	Picture 2	●
AL-2EL-D20.0	20.0	20	75	150	2	Picture 2	●

● Stock available ○ Make-to-order

Indexable milling tools

Solid carbide end mills

AL series

➤ Applicable workpiece material table ○ Very suitable ○ Suitable

Workpiece material											
Carbon steel	Alloy steel	Pre-hardened steel, Hardened steel				Stainless steel	Cast iron, Nodular cast iron	Copper alloy	Aluminum alloy	Titanium alloy	Heat resistant alloy
		~40HRC	~50HRC	~55HRC	~68HRC						
								○			

Code key

B258

Graphics category and identification

B259

Cutting parameters

B549

Non-standard customization

B570-B571