

HMX series for machining high hardness steel

2-flute ball nose end mills with straight shank, long neck and short cutting edge

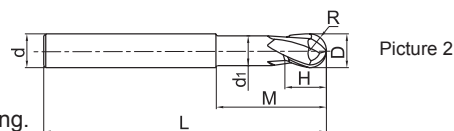

HMX-2BFP

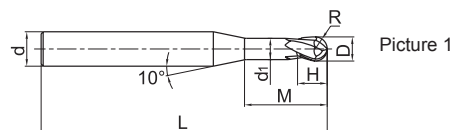

- Short cutting edge and high rigidity designed, applicable for heavy cutting.

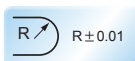

Type	Basic dimension(mm)							Number of teeth Z	Geometry	Stock
	D	R	H	d ₁	M	d	L			
HMX-2BFP-R0.5	1.0	0.5	1	0.95	2.5	6	75	2	Picture 1	●
HMX-2BFP-R0.75	1.5	0.75	1.5	1.45	3.0	6	75	2	Picture 1	●
HMX-2BFP-R1.0	2.0	1.0	2	1.95	4.0	6	75	2	Picture 1	●
HMX-2BFP-R1.5	3.0	1.5	3	2.85	6.0	6	75	2	Picture 1	●
HMX-2BFP-R2.0	4.0	2.0	4	3.85	8.0	6	75	2	Picture 1	●
HMX-2BFP-R2.5	5.0	2.5	5	4.85	10.0	6	75	2	Picture 1	●
HMX-2BFP-R3.0	6.0	3.0	6	5.8	12.0	6	75	2	Picture 2	●
HMX-2BFP-R4.0	8.0	4.0	8	7.8	16.0	8	100	2	Picture 2	●
HMX-2BFP-R5.0	10.0	5.0	10	9.6	20.0	10	100	2	Picture 2	●
HMX-2BFP-R6.0	12.0	6.0	12	11.5	24.0	12	100	2	Picture 2	●
HMX-2BFP-R8.0	16.0	8.0	16	15.5	32.0	16	150	2	Picture 2	●
HMX-2BFP-R10.0	20.0	10.0	20	19.5	40.0	20	150	2	Picture 2	●

● Stock available ○ Make-to-order

Indexable milling tools

Solid carbide end mills

HMX series

Applicable workpiece material table

● Very suitable ○ Suitable

Workpiece material											
Carbon steel	Alloy steel	Pre-hardened steel, Hardened steel				Stainless steel	Cast iron, Nodular cast iron	Copper alloy	Aluminum alloy	Titanium alloy	Heat resistant alloy
		~40HRC	~50HRC	~55HRC	~68HRC						
			○	●	●		○				

Code key

B258

Graphics category and identification

B259

Cutting parameters

B533

Non-standard customization

B570-B571