

4-flute ball nose end mills with long shank



GM-4BL/M/X



● GM-4B series with long shank.

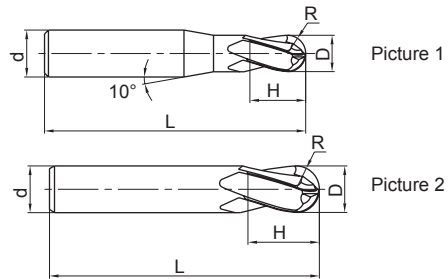
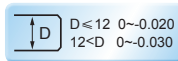
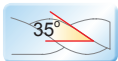

Type	Basic dimension(mm)					Number of teeth Z	Geometry	Stock
	D	R	d	H	L			
GM-4BL-R1.5S	3.0	1.5	4	6	75	4	Picture 1	○
GM-4BL-R1.5	3.0	1.5	6	6	75	4	Picture 1	○
GM-4BL-R2.0S	4.0	2.0	4	8	75	4	Picture 2	○
GM-4BL-R2.0	4.0	2.0	6	8	75	4	Picture 1	○
GM-4BL-R2.5	5.0	2.5	6	10	75	4	Picture 1	○
GM-4BL-R3.0	6.0	3.0	6	12	75	4	Picture 2	○
GM-4BX-R3.0	6.0	3.0	6	12	100	4	Picture 2	○
GM-4BM-R4.0	8.0	4.0	8	16	75	4	Picture 2	○
GM-4BL-R4.0	8.0	4.0	8	16	100	4	Picture 2	○
GM-4BL-R5.0	10.0	5.0	10	20	100	4	Picture 2	○
GM-4BX-R5.0	10.0	5.0	10	20	150	4	Picture 2	○
GM-4BL-R6.0	12.0	6.0	12	24	100	4	Picture 2	○
GM-4BX-R6.0	12.0	6.0	12	24	150	4	Picture 2	○
GM-4BL-R7.0	14.0	7.0	14	28	100	4	Picture 2	○
GM-4BL-R8.0	16.0	8.0	16	32	150	4	Picture 2	○
GM-4BL-R9.0	18.0	9.0	18	36	150	4	Picture 2	○
GM-4BL-R10.0	20.0	10.0	20	40	150	4	Picture 2	○

● Stock available ○ Make-to-order

Indexable milling tools

Solid carbide end mills

GM series

Applicable workpiece material table ●Very suitable ○Suitable

Workpiece material											
Carbon steel	Alloy steel	Pre-hardened steel, Hardened steel				Stainless steel	Cast iron, Nodular cast iron	Copper alloy	Aluminum alloy	Titanium alloy	Heat resistant alloy
		~40HRC	~50HRC	~55HRC	~68HRC						
●	●	●	○			○	●				

Code key B258

Graphics category and identification B259

Cutting parameters B516

Non-standard customization B570-B571

2-flute tiny ball nose end mills with straight shank



GM-2BS

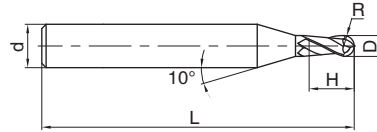
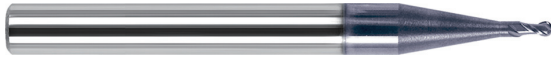

● Tiny diameter end mills can fully display high speed and high precision performances of machining center, often used for machining of precision components such as electronic part etc.

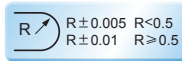
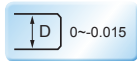
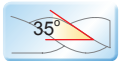

Type	Basic dimension(mm)					Number of teeth Z	Stock
	D	R	d	H	L		
GM-2BS-R0.15	0.30	0.15	4	0.5	50	2	●
GM-2BS-R0.20	0.40	0.20	4	0.6	50	2	●
GM-2BS-R0.25	0.50	0.25	4	0.8	50	2	●
GM-2BS-R0.30	0.60	0.30	4	0.9	50	2	●
GM-2BS-R0.35	0.70	0.35	4	1.0	50	2	●
GM-2BS-R0.40	0.80	0.40	4	1.2	50	2	●
GM-2BS-R0.45	0.90	0.45	4	1.3	50	2	●
GM-2BS-R0.50	1.00	0.50	4	1.5	50	2	●
GM-2BS-R0.60	1.20	0.60	4	1.8	50	2	●
GM-2BS-R0.70	1.40	0.70	4	2.0	50	2	●
GM-2BS-R0.75	1.50	0.75	4	2.3	50	2	●
GM-2BS-R0.80	1.60	0.80	4	2.5	50	2	●
GM-2BS-R0.90	1.80	0.90	4	2.7	50	2	●
GM-2BS-R1.00	2.00	1.00	4	3.0	50	2	●
GM-2BS-R1.25	2.50	1.25	4	3.7	50	2	●
GM-2BS-R1.50	3.00	1.50	4	4.5	50	2	●

● Stock available ○ Make-to-order

Indexable milling tools

Solid carbide end mills

GM series

Applicable workpiece material table ●Very suitable ○Suitable

Workpiece material											
Carbon steel	Alloy steel	Pre-hardened steel、Hardened steel				Stainless steel	Cast iron, Nodular cast iron	Copper alloy	Aluminum alloy	Titanium alloy	Heat resistant alloy
		~40HRC	~50HRC	~55HRC	~68HRC						
○	○	○	○			○	○				

