

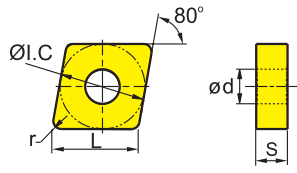

General Turning Inserts

- Cemented carbide and cermet inserts

CN (Negative inserts)





P	Steel
M	Stainless steel
K	Cast iron
N	Non-ferrous metal
S	Heat resistant alloy, Ti alloy

😊 Good working condition 😐 Normal working condition 😞 Bad working condition

P	😊 😊 😋 😌 😍 😎 😏 😐 😑 😒 😓 😔 😕 😖 😗 😘 😙 😚 😛 😜 😝 😞 😟 😠 😡 😢 😣 😤 😥 😦 😧 😨 😩 😪 😫 😬 😭 😮 😯 😰 😱 😲 😳 😴 😵 😶 😷 😸 😹 😺 😻 😼 😽 😾 😿 😺
M	😊 😊 😋 😌 😍 😎 😏 😐 😑 😒 😓 😔 😕 😖 😗 😘 😙 😚 😛 😜 😝 😞 😟 😠 😡 😢 😣 😤 😥 😦 😧 😨 😩 😪 😫 😬 😭 😮 😯 😰 😱 😲 😳 😴 😵 😶 😷 😸 😹 😺 😻 😼 😽 😾 😿 😺
K	😊 😊 😋 😌 😍 😎 😏 😐 😑 😒 😓 😔 😕 😖 😗 😘 😙 😚 😛 😜 😝 😞 😟 😠 😡 😢 😣 😤 😥 😦 😧 😨 😩 😪 😫 😬 😭 😮 😯 😰 😱 😲 😳 😴 😵 😶 😷 😸 😹 😺 😻 😼 😽 😾 😿 😺
N	😊 😊 😋 😌 😍 😎 😏 😐 😑 😒 😓 😔 😕 😖 😗 😘 😙 😚 😛 😜 😝 😞 😟 😠 😡 😢 😣 😤 😥 😦 😧 😨 😩 😪 😫 😬 😭 😮 😯 😰 😱 😲 😳 😴 😵 😶 😷 😸 😹 😺 😻 😼 😽 😾 😿 😺
S	😊 😊 😋 😌 😍 😎 😏 😐 😑 😒 😓 😔 😕 😖 😗 😘 😙 😚 😛 😜 😝 😞 😟 😠 😡 😢 😣 😤 😥 😦 😧 😨 😩 😪 😫 😬 😭 😮 😯 😰 😱 😲 😳 😴 😵 😶 😷 😸 😹 😺 😻 😼 😽 😾 😿 😺

General turning

Cemented carbide and cermet inserts

Inserts shape	Type	Dimensions(mm)					Coated cemented carbide																Cermet Coated cermet	Cemented carbide										
		L	ØI.C	S	ød	r	YBC151	YBC152	YBC251	YBC252	YBC351	YBC352	YBG102	YBG105	YBG202	YBG205	YBG212	YBG302	YBM151	YBM153	YBM215	YBM251			YBM253	YBS103	YBD052	YBD102	YBD152	YBD252				
DM  For semi-finishing	CNMG090304-DM	9.7	9.525	3.18	3.81	0.4	○	●	○																									
	CNMG090308-DM	9.7	9.525	3.18	3.81	0.8			○	○																								
	CNMG120404-DM	12.9	12.7	4.76	5.16	0.4	★	●	★	○					●			○																
	CNMG120408-DM	12.9	12.7	4.76	5.16	0.8	●	★	●	★	●				●			●	○				●											
	CNMG120412-DM	12.9	12.7	4.76	5.16	1.2	★	●	★	●						○							●											
	CNMG120416-DM	12.9	12.7	4.76	5.16	1.6			●	○	●													○										
	CNMG160608-DM	16.1	15.875	6.35	6.35	0.8	★	●	★	○													●											
	CNMG160612-DM	16.1	15.875	6.35	6.35	1.2	○	●	★	○														○										
	CNMG160616-DM	16.1	15.875	6.35	6.35	1.6	★	●	○	●														○										
	CNMG190608-DM	19.3	19.05	6.35	7.94	0.8	○	●	○															○										
	CNMG190612-DM	19.3	19.05	6.35	7.94	1.2	★	●	★	○														○										
	CNMG190616-DM	19.3	19.05	6.35	7.94	1.6			●	★	○													○										
EM  For semi-finishing	CNMG120404-EM	12.9	12.7	4.76	5.16	0.4									●	★					★		★											
	CNMG120408-EM	12.9	12.7	4.76	5.16	0.8									●	★						★		★										
	CNMG120412-EM	12.9	12.7	4.76	5.16	1.2									●	★						★		★										
	CNMG160608-EM	16.1	15.875	6.35	6.35	0.8							○		○	★						○		★										
	CNMG160612-EM	16.1	15.875	6.35	6.35	1.2									○	★						○		★										
	CNMG160616-EM	16.1	15.875	6.35	6.35	1.6									○	★						○		★										

★ Recommended grade (always stock available) ● Available grade (always stock available) ○ Make-to-order

Applicable tool



Page A166 A172 A173 A212

CN□□ (Negative inserts)

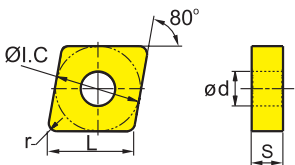

😊 Good working condition 😐 Normal working condition ☹ Bad working condition

Workpiece material	Steel (P)	Stainless steel (M)	Cast iron (K)	Non-ferrous metal (N)	Heat resistant alloy, Ti alloy (S)
Steel (P)	😊😊😊😊😊😊😊😊😊😊	😊😊😊😊😊😊😊😊😊😊	😊😊😊😊😊😊😊😊😊😊	😊😊😊😊😊😊😊😊😊😊	😊😊😊😊😊😊😊😊😊😊
Stainless steel (M)	😊😊😊😊😊😊😊😊😊😊	😊😊😊😊😊😊😊😊😊😊	😊😊😊😊😊😊😊😊😊😊	😊😊😊😊😊😊😊😊😊😊	😊😊😊😊😊😊😊😊😊😊
Cast iron (K)	😊😊😊😊😊😊😊😊😊😊	😊😊😊😊😊😊😊😊😊😊	😊😊😊😊😊😊😊😊😊😊	😊😊😊😊😊😊😊😊😊😊	😊😊😊😊😊😊😊😊😊😊
Non-ferrous metal (N)	😊😊😊😊😊😊😊😊😊😊	😊😊😊😊😊😊😊😊😊😊	😊😊😊😊😊😊😊😊😊😊	😊😊😊😊😊😊😊😊😊😊	😊😊😊😊😊😊😊😊😊😊
Heat resistant alloy, Ti alloy (S)	😊😊😊😊😊😊😊😊😊😊	😊😊😊😊😊😊😊😊😊😊	😊😊😊😊😊😊😊😊😊😊	😊😊😊😊😊😊😊😊😊😊	😊😊😊😊😊😊😊😊😊😊

Inserts shape	Type	Dimensions(mm)						Coated cemented carbide															Cermet Coated cermet	Cermet	Cemented carbide														
		L	ØI.C	S	ød	r	YBC151	YBC152	YBC251	YBC252	YBC351	YBC352	YBG102	YBG105	YBG202	YBG205	YBG212	YBG302	YBM151	YBM153	YBM215	YBM251				YBM253	YBS103	YBD052	YBD102	YBD152	YBD252	YNG151	YNG151C	YD101	YD201				
NM For semi-finishing	CNMG120404-NM	12.9	12.7	4.76	5.16	0.4																																	
	CNMG120408-NM	12.9	12.7	4.76	5.16	0.8							○	★																									
	CNMG120412-NM	12.9	12.7	4.76	5.16	1.2							○	★																									
LR Light-load roughing	CNMM120408-LR	12.9	12.7	4.76	5.16	0.8																																	
	CNMM120412-LR	12.9	12.7	4.76	5.16	1.2																																	
	CNMM120416-LR	12.9	12.7	4.76	5.16	1.6																																	
	CNMM160608-LR	16.1	15.875	6.35	6.35	0.8																																	
	CNMM160612-LR	16.1	15.875	6.35	6.35	1.2																																	
	CNMM160616-LR	16.1	15.875	6.35	6.35	1.6																																	
	CNMM160624-LR	16.1	15.875	6.35	6.35	2.4																																	
	CNMM190612-LR	19.3	19.05	6.35	7.94	1.2																																	
	CNMM190616-LR	19.3	19.05	6.35	7.94	1.6																																	
	CNMM190624-LR	19.3	19.05	6.35	7.94	2.4																																	
	CNMM250924-LR	25.79	25.4	9.525	9.12	2.4																																	

★ Recommended grade (always stock available) ● Available grade (always stock available) ○ Make-to-order

General turning

Cemented carbide and cermet inserts

Applicable tool



Insert code key: A50-A51 Grade selection reference: A19/A36-A48 Chipbreaker selection reference: A22-A35 Recommended cutting parameters: A241-A244

CN □ □ (Negative inserts)

😊 Good working condition 😐 Normal working condition 😞 Bad working condition

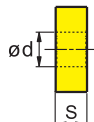
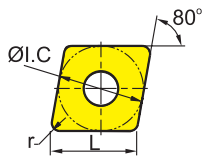

Workpiece material	Steel	Stainless steel	Cast iron	Non-ferrous metal	Heat resistant alloy, Ti alloy
P Steel	😊😊😊😊😊😊😊😊	😊😊😊😊😊😊😊😊	😊😊😊😊😊😊😊😊	😊😊😊😊😊😊😊😊	😊😊😊😊😊😊😊😊
M Stainless steel	😊😊😊😊😊😊😊😊	😊😊😊😊😊😊😊😊	😊😊😊😊😊😊😊😊	😊😊😊😊😊😊😊😊	😊😊😊😊😊😊😊😊
K Cast iron	😊😊😊😊😊😊😊😊	😊😊😊😊😊😊😊😊	😊😊😊😊😊😊😊😊	😊😊😊😊😊😊😊😊	😊😊😊😊😊😊😊😊
N Non-ferrous metal	😊😊😊😊😊😊😊😊	😊😊😊😊😊😊😊😊	😊😊😊😊😊😊😊😊	😊😊😊😊😊😊😊😊	😊😊😊😊😊😊😊😊
S Heat resistant alloy, Ti alloy	😊😊😊😊😊😊😊😊	😊😊😊😊😊😊😊😊	😊😊😊😊😊😊😊😊	😊😊😊😊😊😊😊😊	😊😊😊😊😊😊😊😊

Inserts shape	Type	Dimensions(mm)					Coated cemented carbide																	Cermet	Coated cermet	Cemented carbide										
		L	ØI.C.	S	ød	r	YBC151	YBC152	YBC251	YBC252	YBC351	YBC352	YBG102	YBG105	YBG202	YBG205	YBG212	YBG302	YBM151	YBM153	YBM215	YBM251	YBM253				YBS103	YBD052	YBD102	YBD152	YBD252	YNG151	YNG151C	YD101	YD201	
HDR For heavy machining	CNMM120408-HDR	12.9	12.7	4.76	5.16	0.8	○	●	○	○	○																									
	CNMM120412-HDR	12.9	12.7	4.76	5.16	1.2			○	○	○	○																								
	CNMM120416-HDR	12.9	12.7	4.76	5.16	1.6			○	○	○	○																								
	CNMM160612-HDR	16.1	15.875	6.35	6.35	1.2			○	○	○	○																								
	CNMM160616-HDR	16.1	15.875	6.35	6.35	1.6				○	○	○																								
	CNMM190616-HDR	19.3	19.05	6.35	7.94	1.6				○	○	○	○																							
	CNMM190624-HDR	19.3	19.05	6.35	7.94	2.4			○	○	○	○	○																							
HPR For heavy machining	CNMM190616-HPR	19.5	19.05	6.35	7.94	1.6																														
	CNMM250924-HPR	25.19	25.4	9.525	9.12	2.4																														
Without chipbreaker 	CNMA120404	12.9	12.7	4.76	5.16	0.4																														
	CNMA120408	12.9	12.7	4.76	5.16	0.8																														
	CNMA120412	12.9	12.7	4.76	5.16	1.2																														
	CNMA120416	12.9	12.7	4.76	5.16	1.6																														
	CNMA160608	16.1	15.875	6.35	6.35	0.8																														
	CNMA160612	16.1	15.875	6.35	6.35	1.2																														
	CNMA160616	16.1	15.875	6.35	6.35	1.6																														
	CNMA160620	16.1	15.875	6.35	6.35	2.0																														
	CNMA160630	16.1	15.875	6.35	6.35	3.0																														
	CNMA190612	19.3	19.05	6.35	7.94	1.2																														
	CNMA190616	19.3	19.05	6.35	7.94	1.6																														

★ Recommended grade (always stock available) ● Available grade (always stock available) ○ Make-to-order

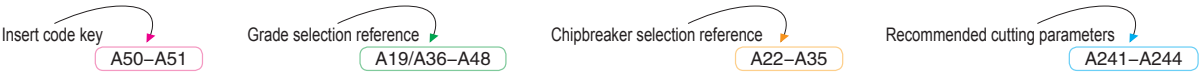
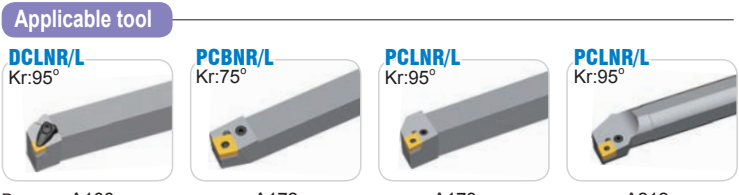

CN (Negative inserts)

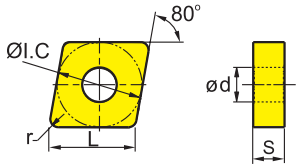

P Steel
M Stainless steel
K Cast iron
N Non-ferrous metal
S Heat resistant alloy, Ti alloy

Good working condition
 Normal working condition
 Bad working condition

Material	YBC151	YBC152	YBC251	YBC252	YBC351	YBC352	YBG102	YBG105	YBG202	YBG205	YBG212	YBG302	YBM151	YBM153	YBM215	YBM251	YBM253	YBS103	YBD052	YBD102	YBD152	YBD252	YNG151	YNG151C	YD101	YD201
Steel	😊😊😊😊😊😊😊😊											😊😊😊😊😊😊😊😊											😊😊😊😊😊😊😊😊			
Stainless steel										😊😊😊😊😊😊😊😊													😊😊😊😊😊😊😊😊			
Cast iron																							😊😊😊😊😊😊😊😊			
Non-ferrous metal																							😊😊😊😊😊😊😊😊			
Heat resistant alloy, Ti alloy	😊😊😊😊😊😊😊😊																						😊😊😊😊😊😊😊😊			

General turning

Cemented carbide and cermet inserts

Inserts shape	Type	Dimensions(mm)					Coated cemented carbide																Cermet Coated cermet	Cermet Coated cermet	Cemented carbide									
		L	ØI.C	S	ød	r	YBC151	YBC152	YBC251	YBC252	YBC351	YBC352	YBG102	YBG105	YBG202	YBG205	YBG212	YBG302	YBM151	YBM153	YBM215	YBM251				YBM253	YBS103	YBD052	YBD102	YBD152	YBD252	YNG151	YNG151C	YD101
	CNMG120404	12.9	12.7	4.76	5.16	0.4	●	●														●			○									
	CNMG120408	12.9	12.7	4.76	5.16	0.8	●	★	●	★	○												●			★	★	★						
	CNMG120412	12.9	12.7	4.76	5.16	1.2	●	★	●	★															○	○	○							
	CNMG160608	16.1	15.875	6.35	6.35	0.8	●	●															○											
	CNMG160612	16.1	15.875	6.35	6.35	1.2			●	○																								
	CNMG160616	16.1	15.875	6.35	6.35	1.6				○																								
	CNMG190608	19.3	19.05	6.35	7.94	0.8	○	○	○																									
	CNMG190612	19.3	19.05	6.35	7.94	1.2	○	●	○																									
	CNMG190616	19.3	19.05	6.35	7.94	1.6	○	○	○																									
	CNMM120404	12.9	12.7	4.76	5.16	0.4	○																											
	CNMM120408	12.9	12.7	4.76	5.16	0.8	○	○																										
	CNMM120412	12.9	12.7	4.76	5.16	1.2	○																											
	CNMM190608	19.3	19.05	6.35	7.94	0.8				○																								
	CNMM190612	19.3	19.05	6.35	7.94	1.2			○	○																								
	CNMM190616	19.3	19.05	6.35	7.94	1.6			○																									
	CNMM190624	19.3	19.05	6.35	7.94	2.4				○																								

★Recommended grade (always stock available)
 ●Available grade (always stock available)
 ○Make-to-order

Applicable tool

DCLNR/L
Kr:95°



Page A166

PCBNR/L
Kr:75°



A172

PCLNR/L
Kr:95°



A173

PCLNR/L
Kr:95°



A212